



# CONNECTOR CALLOUT



Automatically create notes in the 2D drawings you generate from your 3D CAD models by fetching automatically the existing parameters.

**Compatible with Creo, SolidWorks and Inventor**



## Connector Callout Application

### Application Overview / Market Segment Introduction:

**Connector Callout** is an add-on application developed for Creo (Pro/ENGINEER). **Connector Callout** application automatically create new notes by fetching the parameter in Creo 2D Drawing application/module. It will check connector callout designate parameter with table stored values and will filter content and it will place note in group drawing with filtered content fetched from harness drawing table.

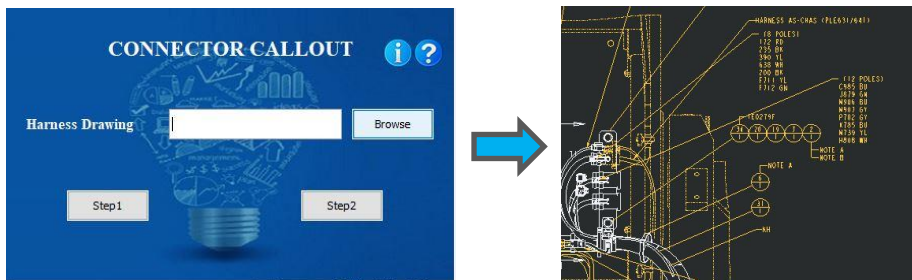

### Current Scenario (Without Application):

#### User need to Manually:

- Actual practice collects the details from harness drawing.
- Create the connector detail in group drawing.

#### Negative consequences:

- Human error will occur due to manual entry for connector detail.
- Mismatching of connector detail.

### Positive Business Outcome:

- **ROI** – quick Return on Investment (ROI) considering the significant time savings and reduced ECN's
  - **Speed** – Few click solution to generate the connector detail.
  - **Enhanced User Productivity** - Eliminate Designer/Creo User's non-productive (manual entries) activities, saving up to 80% time.
- **Standardization** – Standardization of Process as per company standards.
- **Quality output:**
  - **Error Free** – Eliminates errors like mismatching of connector, wrong detail of connector, etc.

### How it adds value:

- Works with PTC Creo (Pro/ ENGINEER) Base (Foundation) Licenses
- Few-click solution that Automatically create new notes by fetching the parameter.
- Works in conjunction with PTC Windchill/ PDM-Link or Intralinks.
- Intuitive, elegant user interface

**List of satisfied users:**

- L&T Technology Services.

**For more information please contact:**

Sylvie Loos  
Head of Services  
Telephone: +49 8441 8596 342  
Email: [sylvie.loos@arsandis.com](mailto:sylvie.loos@arsandis.com)

