

CREO NC NESTING



This Creo add-on assists in border offset & sheet metal component placement based on raw material size.

Compatible with Creo, SolidWorks and Inventor



NC Nesting

Application Overview / Market Segment Introduction:

NC Nesting is an embedded tool inside Creo (Pro/ENGINEER) for border offset & sheet metal component placement based on raw material size.

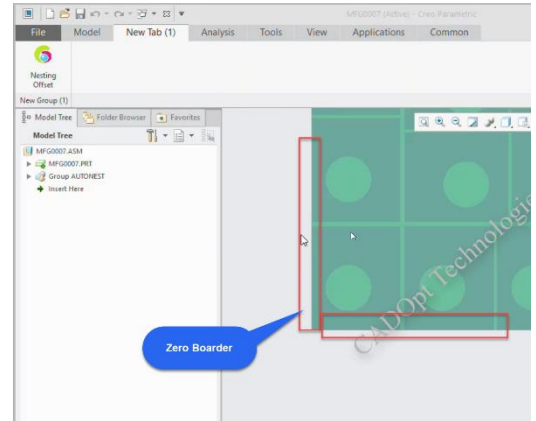
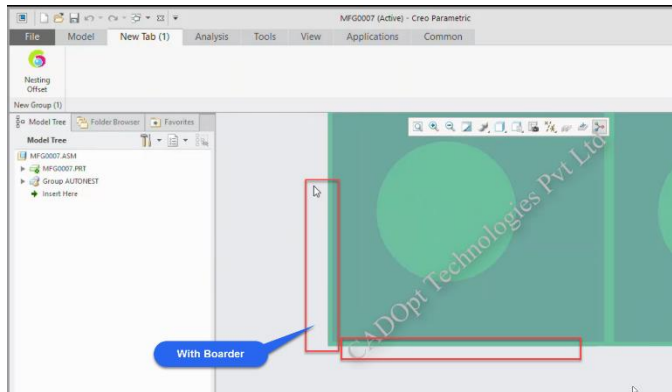

Current Scenario (Without Application):

- ➔ Manually not possible to apply the border offset & sheet metal component placement in NC automation.

Negative consequences:

- Raw material wastage.

Positive Business Outcome:

- **ROI** – quick Return on Investment (ROI) considering the significant reducing raw material usage.
 - **Speed** – One click solution to apply the border offset & sheet metal component placement.
 - **Enhanced User Productivity** - Eliminate Designer's /Creo User's non-productive (manual entries) activities by saving up to 90% design time & save raw material.
- **Quality output:**
 - **Error Free** – Eliminates arrangement errors.

How it adds value:

- Works with PTC Creo (Pro/ ENGINEER) NC Sheetmetal Licenses only.
- One-click solution that automatically determines and apply the border offset.
- Sheet metal component placement with less raw material wastage.
- Recognizes size & shape of the models.

List of satisfied users:

- PTC

For more information please contact:

Sylvie Loos
Head of Services
Telephone: +49 8441 8596 342
Email: sylvie.loos@arsandis.com

